

IRIS DUCT DAMPER

Installation dimensions



Application

The duct damper IRIS has been especially designed for easy measuring and balancing of air flows in circular ducts. These dampers can be used both in supply and exhaust. Each IRIS damper is equipped with 2 manometer connections for measuring the pressure loss/air volume. By the concerning diagram and the measured Δp one can adjust or read the desired air flow. Adjusting is done by a handle. Once adjustment effected it can be locked.

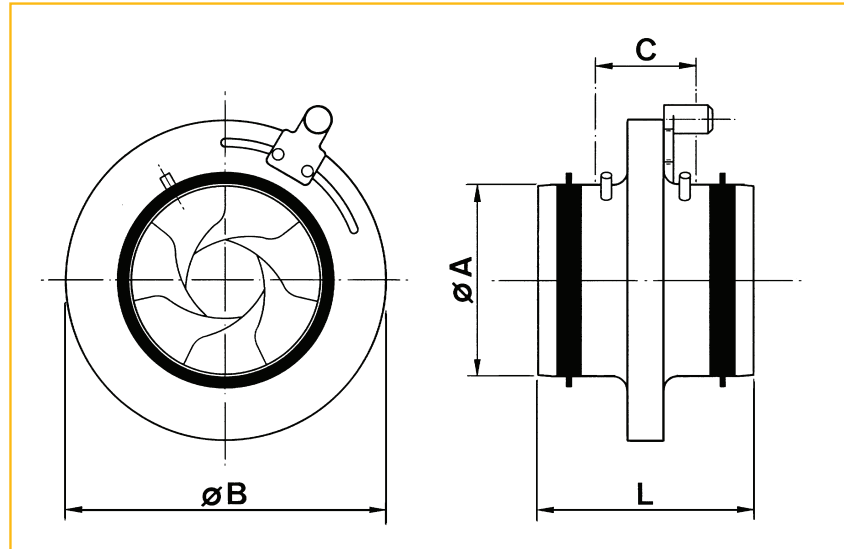

Size	Ø A	Ø B	C	L
100	99	165	50	110
125	124	210	50	110
160	159	230	50	110
200	199	285	50	110
250	249	335	50	110
315	314	420	80	160

All dimensions in mm.

Technical information

Characteristics

- 2 manometer connections
Ø 5 mm with protecting caps
- measuring precision $\pm 5-8 \%$
(mounted following instructions)
- both ends provided with rubber sealing gaskets
- synthetic adjusting button with graduation and locking system
- Available in 6 sizes: 100, 125, 160, 200, 250 and 315 mm

Construction

Made out of galvanised sheet steel

IRIS DUCT DAMPER

Fixing instructions

Direct mounting between two circular ducts

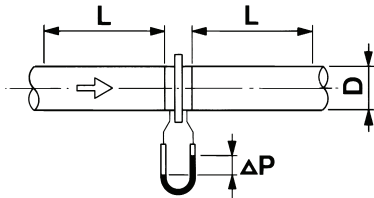

$L \geq 4 D$; air flow : $\pm 5\%$

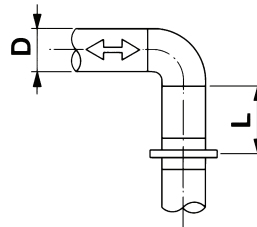

$L \geq 1 D$; air flow : $\pm 8\%$

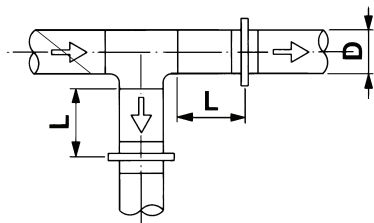

$L \geq 4 D$; air flow : $\pm 8\%$

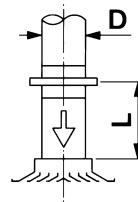

$L \geq 2 D$; air flow : $\pm 8\%$

Specifications description

Example :

IRIS duct damper made out of galvanized sheet steel and equipped on both ends with a rubber sealing gasket. The damper is provided with a lockable adjusting button and 2 manometer connections of $\varnothing 5$ mm.

Type : IRIS
Size : ... mm

How to order

IRIS duct damper, size 100mm.

I	R	I	S	-	-	-	0	1	0	0	0	0	0	0
---	---	---	---	---	---	---	---	---	---	---	---	---	---	---

size

IRIS DUCT DAMPER

Pressure loss

size 100 mm

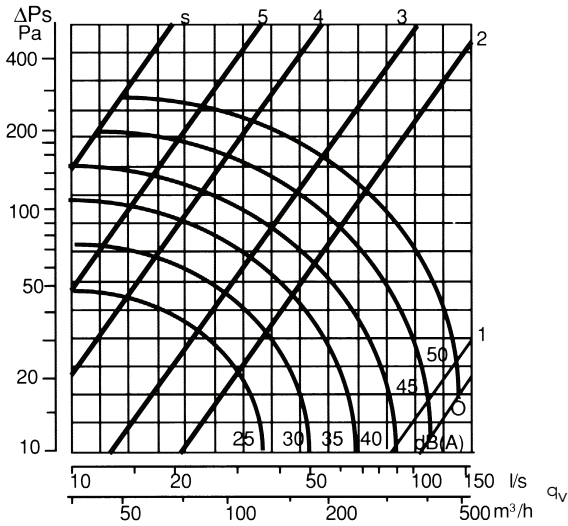

size 125 mm

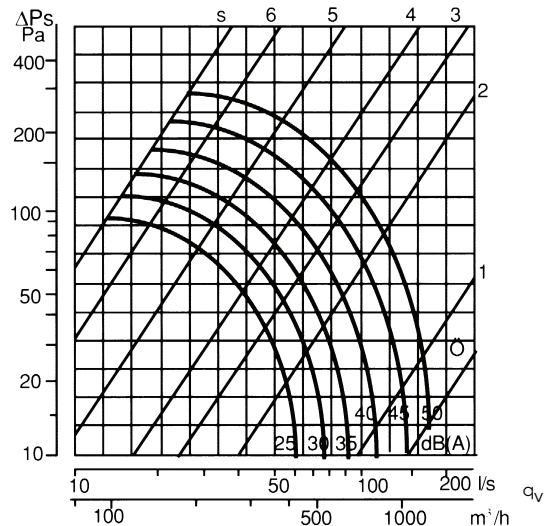

size 160 mm

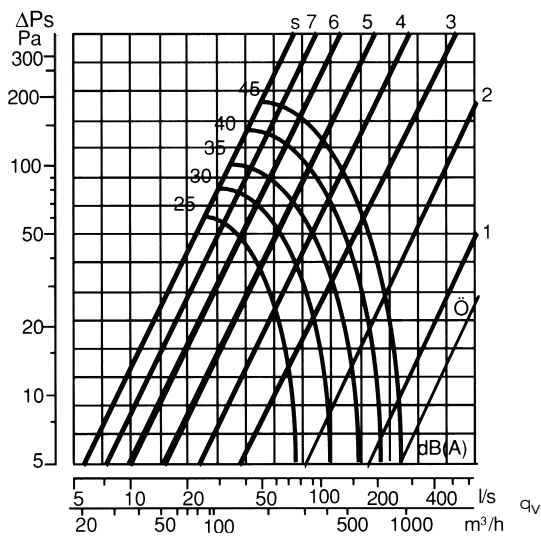

IRIS DUCT DAMPER

Pressure loss

size 200 mm

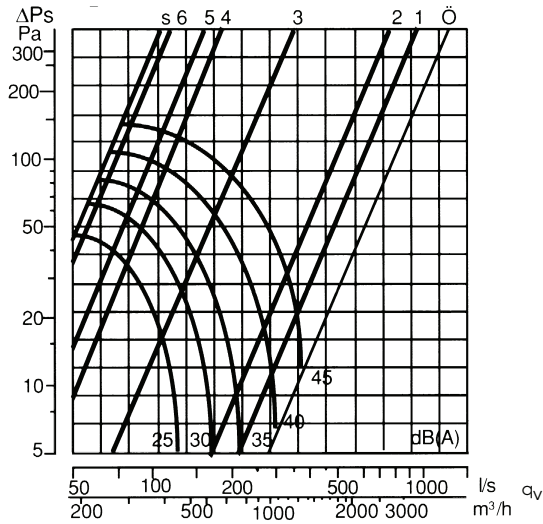

size 250 mm

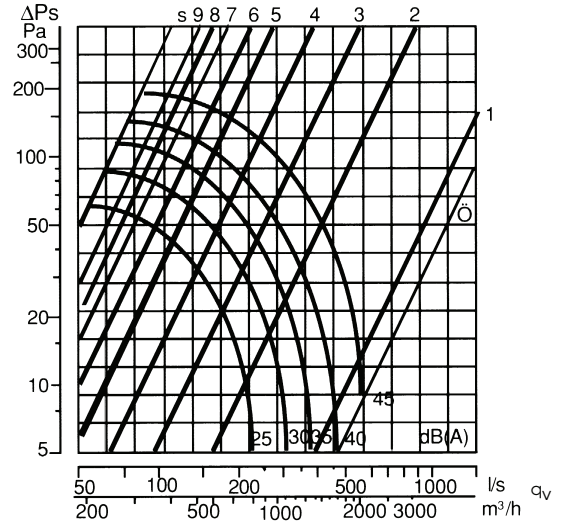

size 315 mm

